

TD/PM Circle-H offshore helideck system

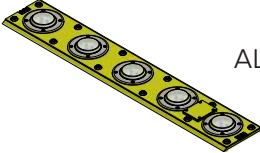

<p>Compliance to standards</p>	<p>ICAO: Doc 9261, Heliport Manual, Fourth Edition, 2020</p>								
<p>Application</p>	<p>Touchdown / positioning markings for offshore heliports</p>								
<p>Features</p>	<p>Designed and built with simplicity and ease of maintenance in mind. High power LED technology. Lightweight, low-energy and environment friendly lighting fitting. Extensive use of aluminium alloys reduces fitting weight and eases handling in the field.</p>								
<p>Product Code</p>	<p>AL - XXX - XX - XX</p> <table data-bbox="555 1630 1385 1796"> <tr> <td>Series Indicator (Airfield Lighting)</td> <td>AL</td> </tr> <tr> <td>Product Indicator</td> <td>XXX</td> </tr> <tr> <td>Number of modules on fixture</td> <td>XX</td> </tr> <tr> <td>LEDs Light Colour (green or yellow)</td> <td>XX</td> </tr> </table>	Series Indicator (Airfield Lighting)	AL	Product Indicator	XXX	Number of modules on fixture	XX	LEDs Light Colour (green or yellow)	XX
Series Indicator (Airfield Lighting)	AL								
Product Indicator	XXX								
Number of modules on fixture	XX								
LEDs Light Colour (green or yellow)	XX								

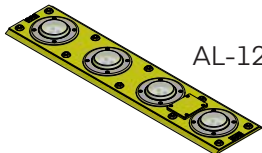
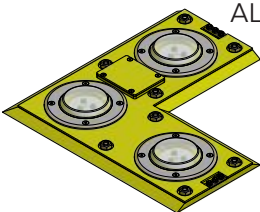
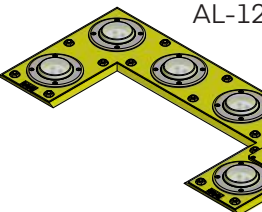
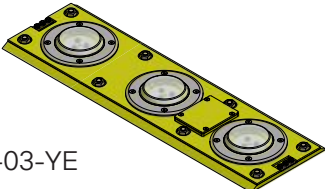

<p>Description</p>	<p>Housing - Powder coated aluminium RAL 1004 (aviation yellow) Dispenser - hardened glass Dispenser flange - nickel plated ring Fasteners - stainless steel</p> <p>Light fixtures are UV protected.</p>
<p>Environment</p>	<p>Temperature range: - 55° to +55° Degree of protection: IP X8 Ka tested: Salt mist in accordance with IEC 60068-2-11 and IEC 60068-2-25</p> <p>The TD/PM circle and H lighting components, fitments and cabling are able to withstand a pressure of 1.655 kPa (240 lbs/in2) and ideally 3 250 kPa (471 lbs/in2) without damage.</p>
<p>Mounting</p>	<p>H TD/PM lights it's made of:</p> <ul style="list-style-type: none"> 4 pcs. AL-122-03-GR 4 pcs. AL-123-06-GR 8 pcs. AL-121-04-GR 6 pcs. AL-120-05-GR <div style="display: flex; justify-content: space-around; align-items: flex-start;"> <div style="text-align: center;">  <p>AL-120-05-GR</p> </div> <div style="text-align: center;">  <p>AL-121-04-GR</p> </div> </div> <div style="display: flex; justify-content: space-around; align-items: flex-start; margin-top: 20px;"> <div style="text-align: center;">  <p>AL-122-03-GR</p> </div> <div style="text-align: center;">  <p>AL-123-06-GR</p> </div> </div> <p>Circle TD/PM lights it's made of:</p> <ul style="list-style-type: none"> 32 pcs AL-124-03-YE <div style="text-align: center; margin-top: 20px;">  <p>AL-124-03-YE</p> </div>

Mechanical Characteristics

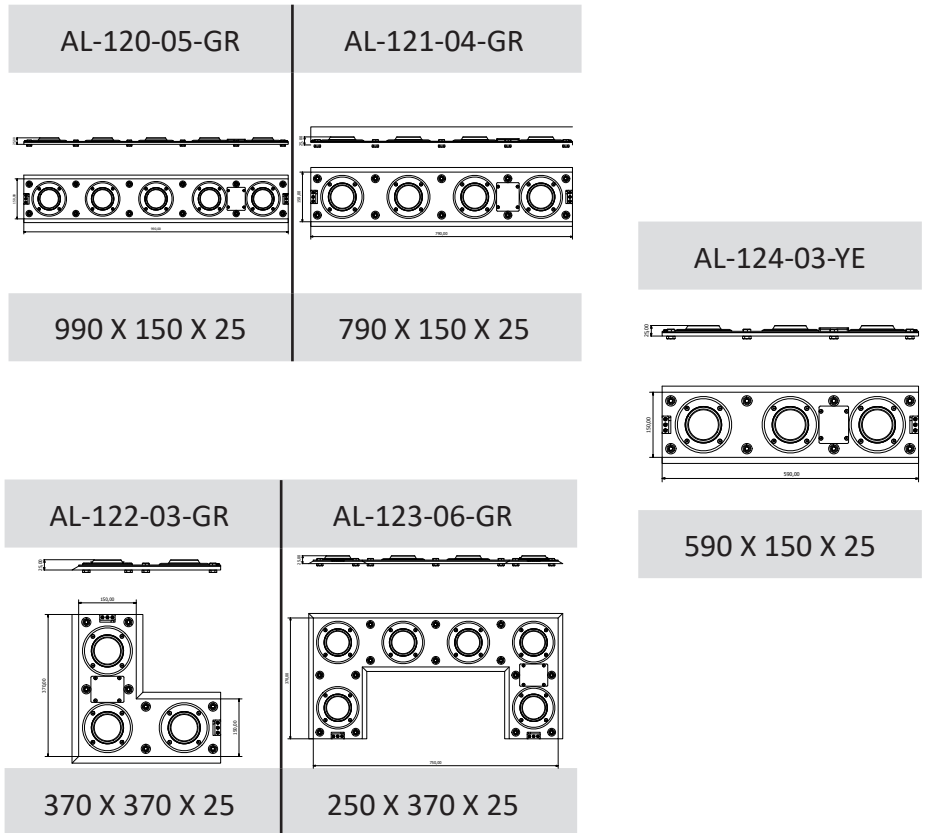

IMPORTANT

The total height of the light fixtures does not exceed 25 mm.

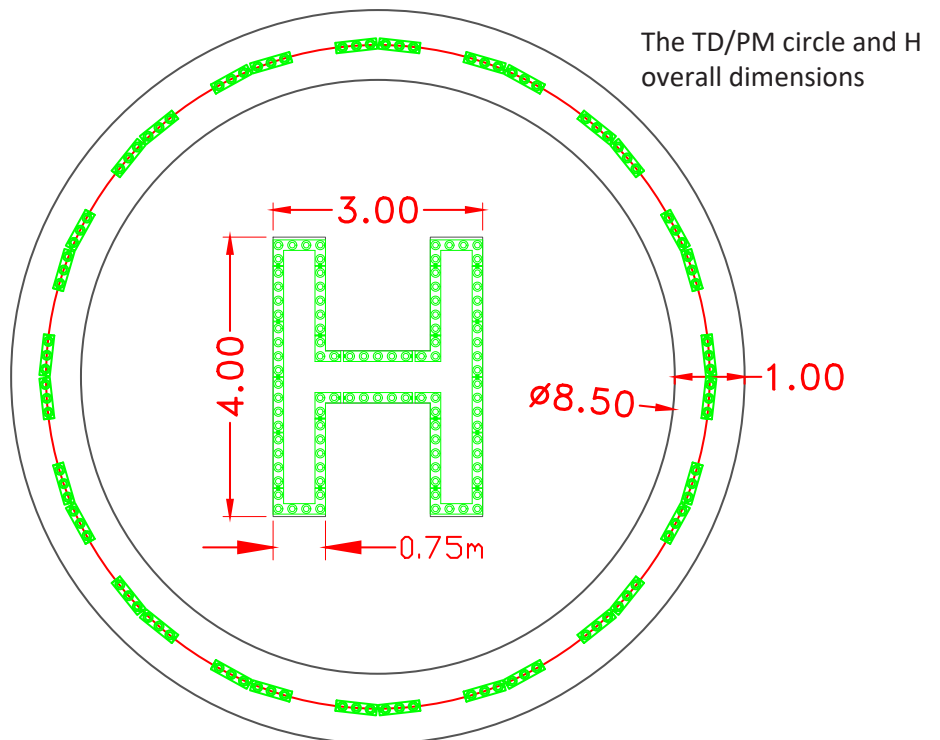

Electrical Characteristics

Power consumption	AL-120-05-GR	10W
	AL-121-04-GR	8W
	AL-122-03-GR	6W
	AL-123-06-GR	12W
	AL-124-03-YE	6W

Electrical Connections

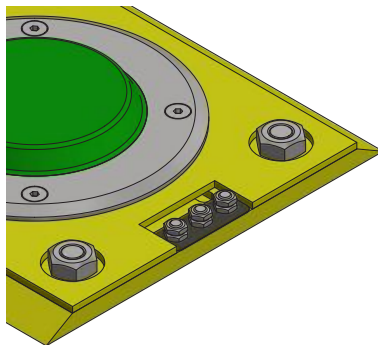

48V DC power supply from controller with 3 core cable
V+ (brown)
V- (blue)
 Dimming (green/yellow)

Cable protection - aluminium

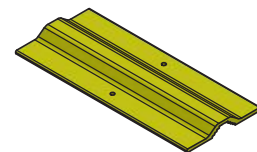
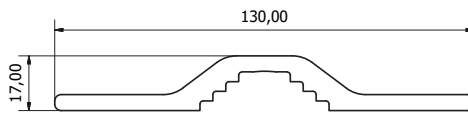

Photometric Characteristics

Light intensity and colour for lighting segments on the TD/PM circle

Horizontal output: 3600
Light Intensity: according to Doc 9261 Heliport Manual Fourth Edition, 2020 Apendix I-B, par. 4.3
Light colour: Yellow light according to Doc 9261 Heliport Manual Fourth Edition, 2020, Apendix I-B. par. 4.4.1

Light intensity and colour for heliport identification marking ('H')

Horizontal output: 3600
Light Intensity: according to Doc 9261 Heliport Manual Fourth Edition, 2020 Apendix I-B, par. 5.3
Light Intensity: Green light according to Doc 9261 Heliport Manual Fourth Edition, 2020, Apendix I-B. par. 5.4.1

Accessory

To order accessories please call our customer support.
For contact details please refer to our website - www.signalight.com



Signalight

+40 254 515 465
office@signalight.com

36 Lunca Street, Petrosani,
Hunedoara County, Romania

www.signalight.com